



Kilkenny County Council  
Comhairle Chontae Chill Chainnigh



Abbey  
Quarter



# KILKENNY

THE BEST OF IRELAND

Abbey Quarter Public Engagement  
Wednesday 18<sup>th</sup> January 2023



where medieval meets modern

## Agenda

This online public engagement

- A short introduction to the project
- Overview of the stakeholder engagement process.
- Review of our public survey findings
- Q & A session reflecting on the results of the survey findings.

Discussions from the webinar along with the findings of the online survey will be fed into the review.

# Masterplan Area Extension & Review

Original Masterplan adopted 2015

Urban Design Code adopted 2018

Land use mix, short medium and long-term areas for phasing

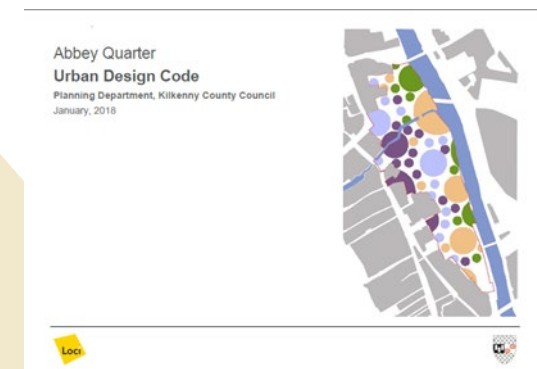

Recognized further design  
development needed.

Vicar Street/Greens Bridge St

Develop the most appropriate  
Urban Design response.

Extract from Section 5.2.3 of Masterplan - Final Masterplan Design

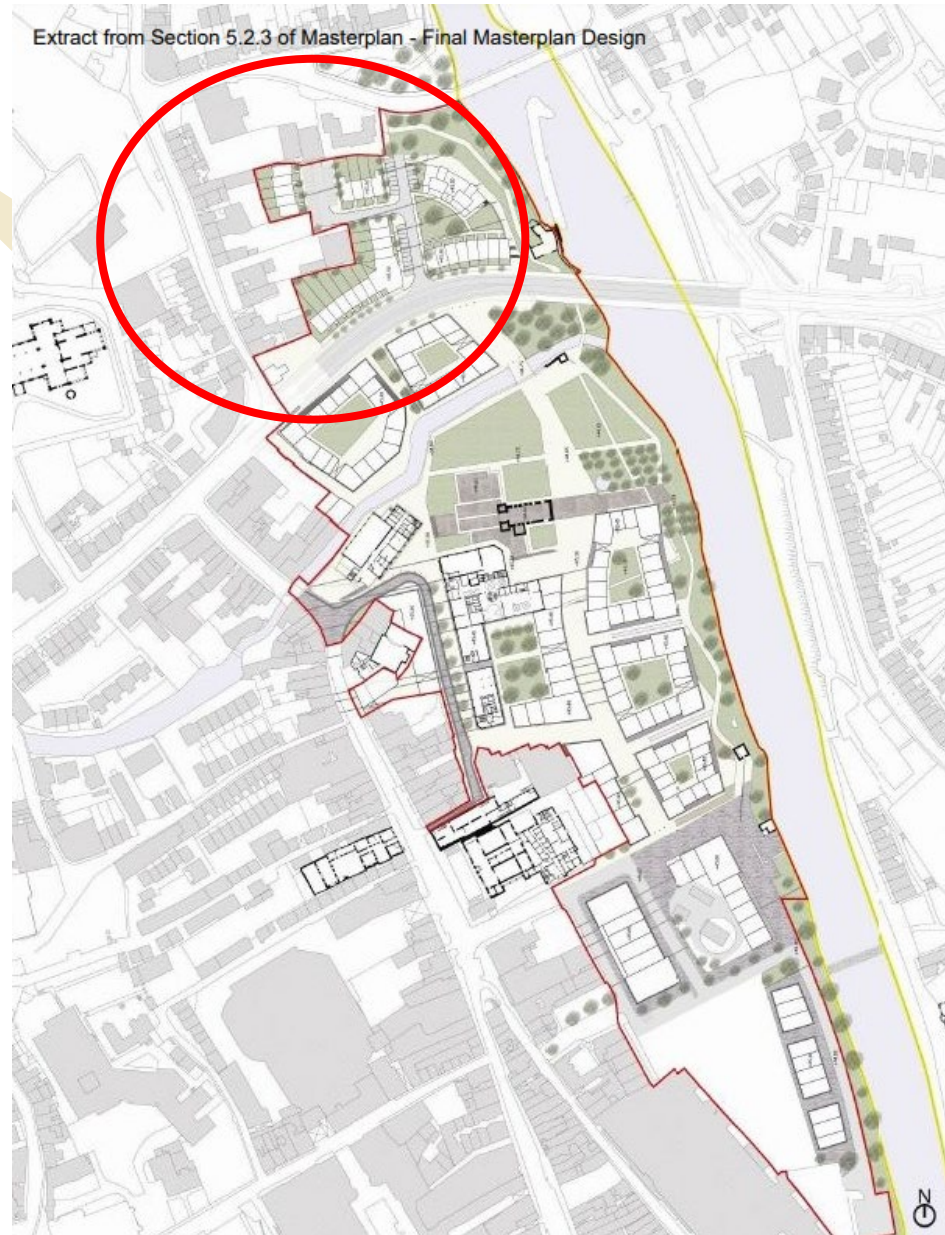



## The Brief

Extend the Plan Area to include:

- Area bounded by Vicar St/Green Bridge St
- Review the phasing
- Extend the principles of the Urban Design Code,
- Advise on housing delivery,
- Review the height restrictions, (Tall buildings)
- Climate Action Adaptation/Mitigation
- Advise on the mix of uses already set out,
- Advise on the accessibility to/from the area

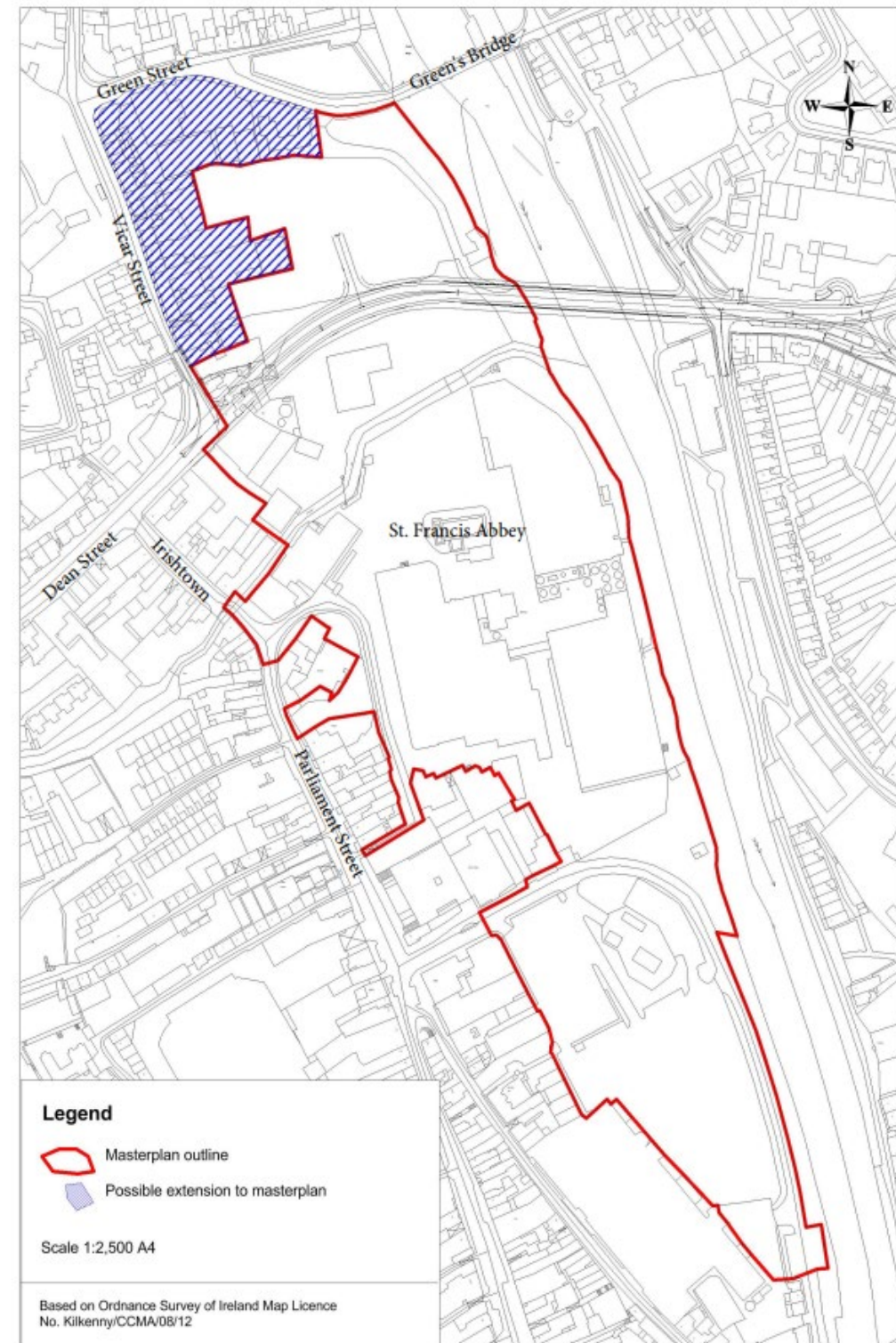

# PROJECTS TO DATE

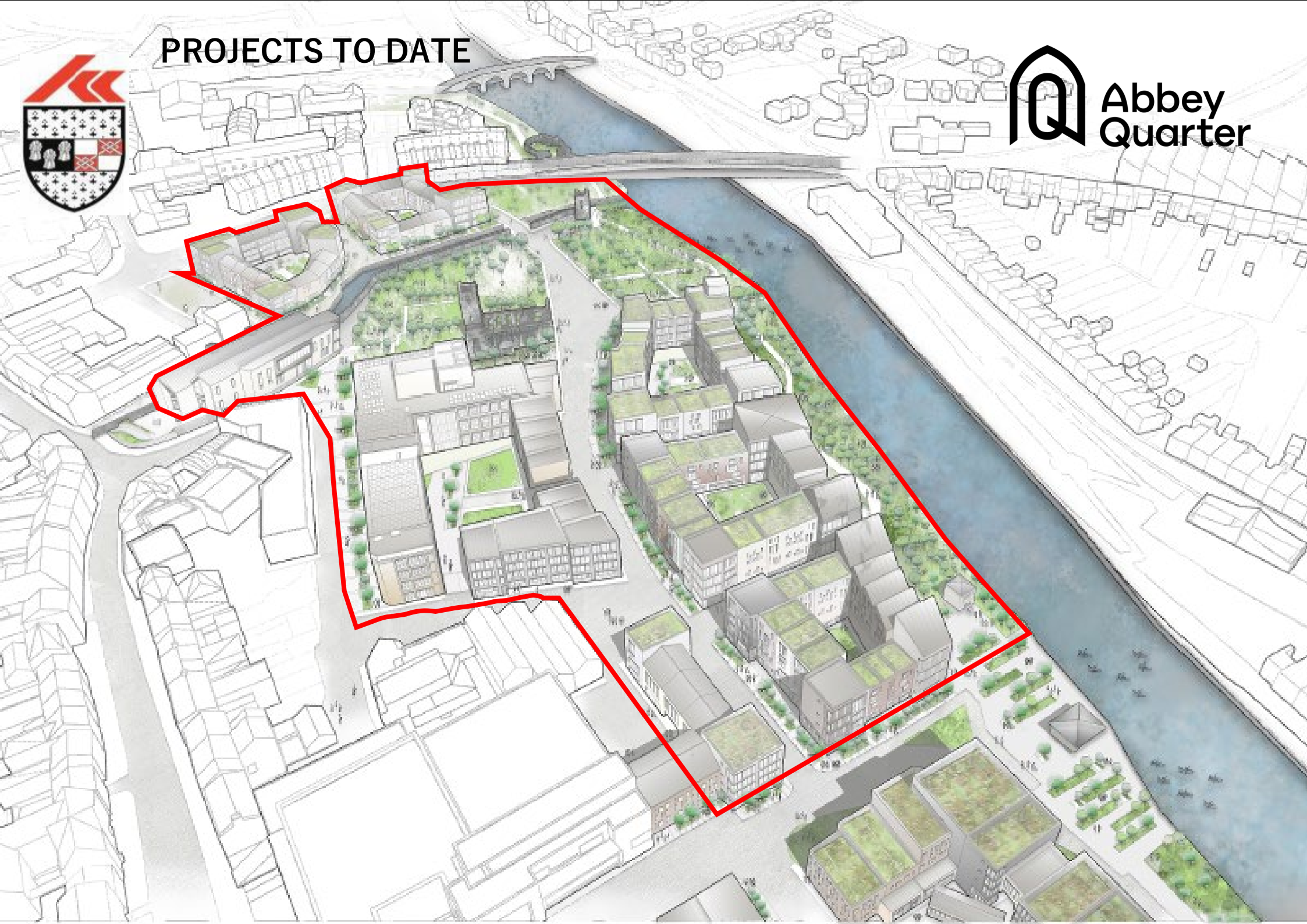

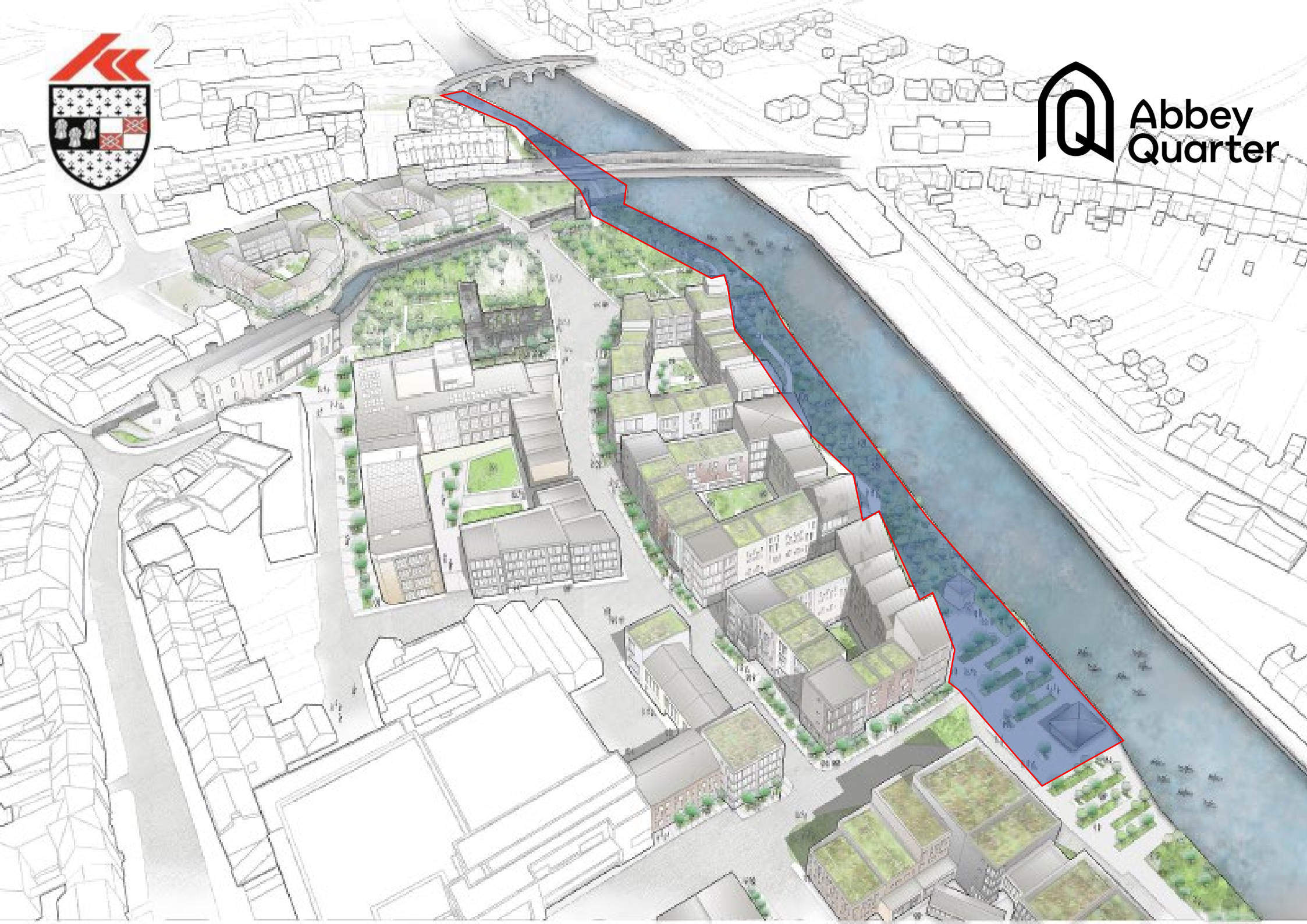



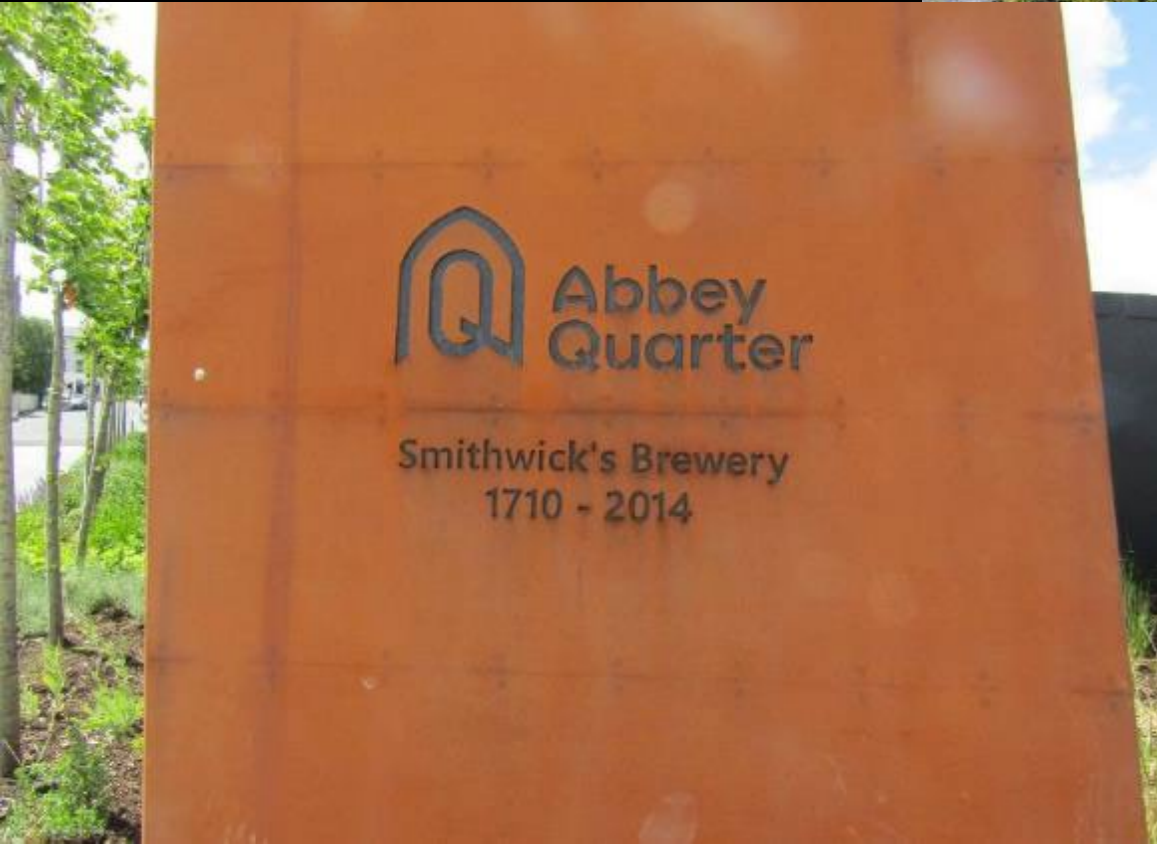











 **Abbey  
Quarter**

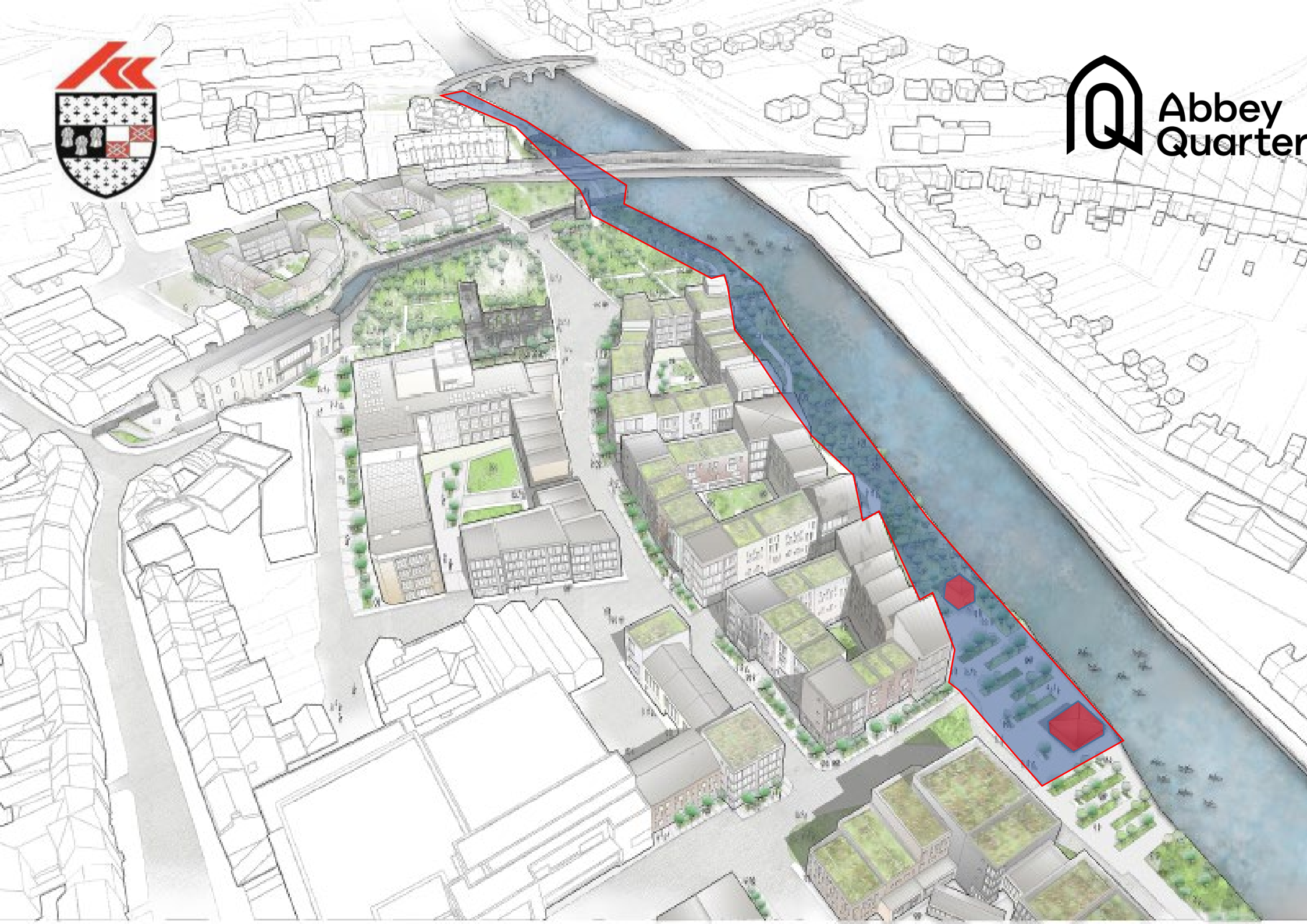





**Tea Houses**





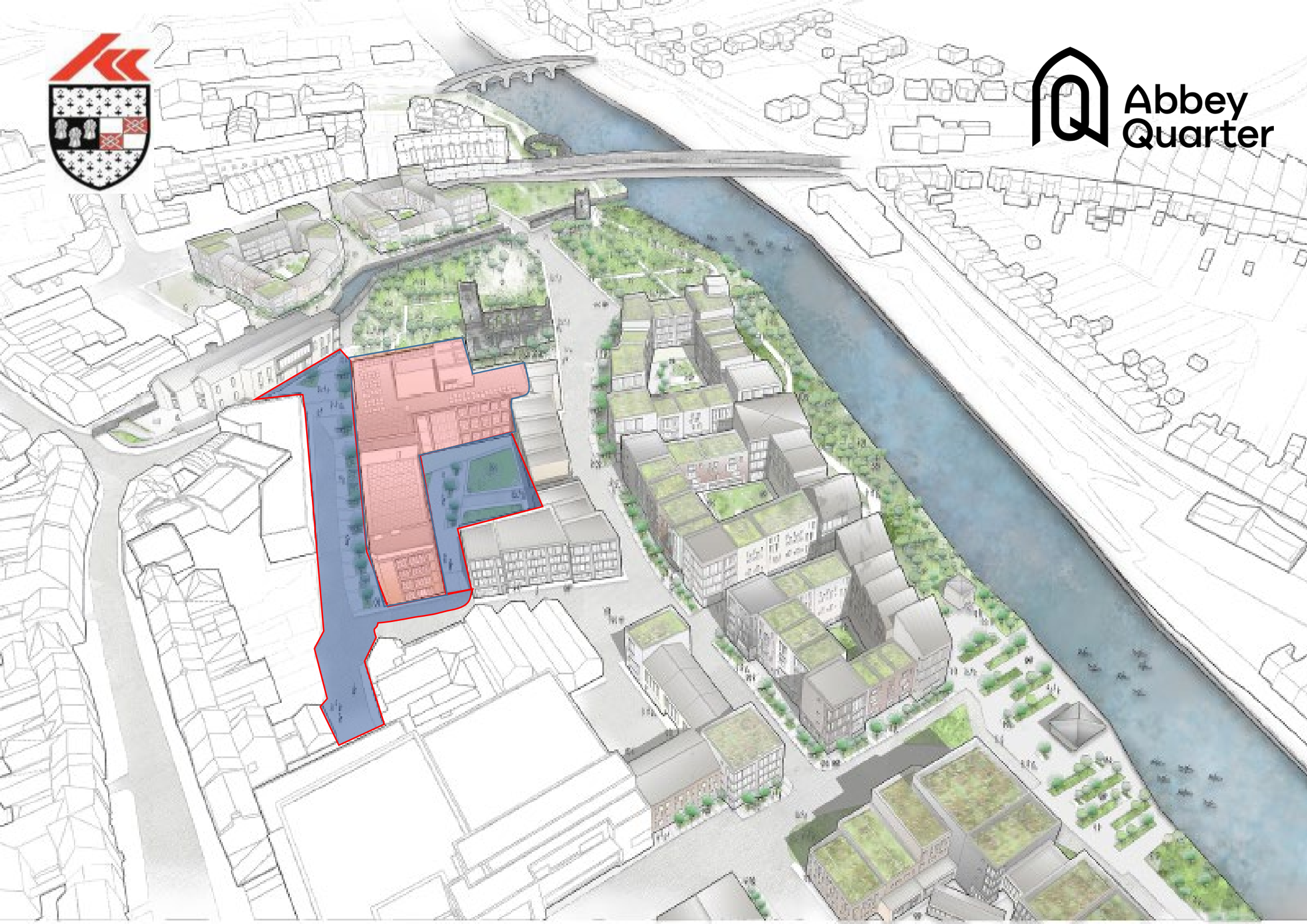









**BREWHOUSE COURTYARD**





 **Abbey  
Quarter**

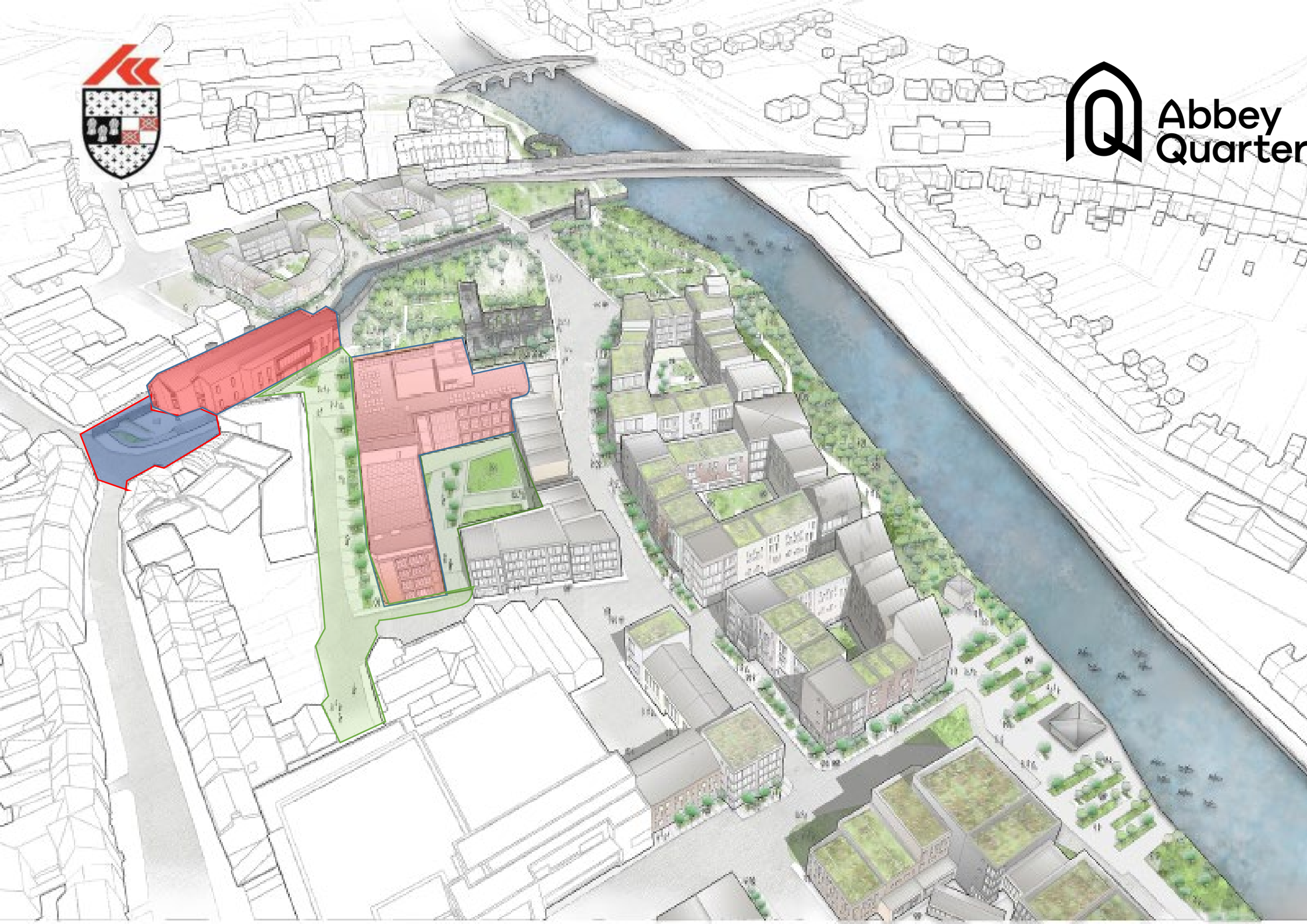



# Mayfair Library









13-01-2023 Fri 09:45:42





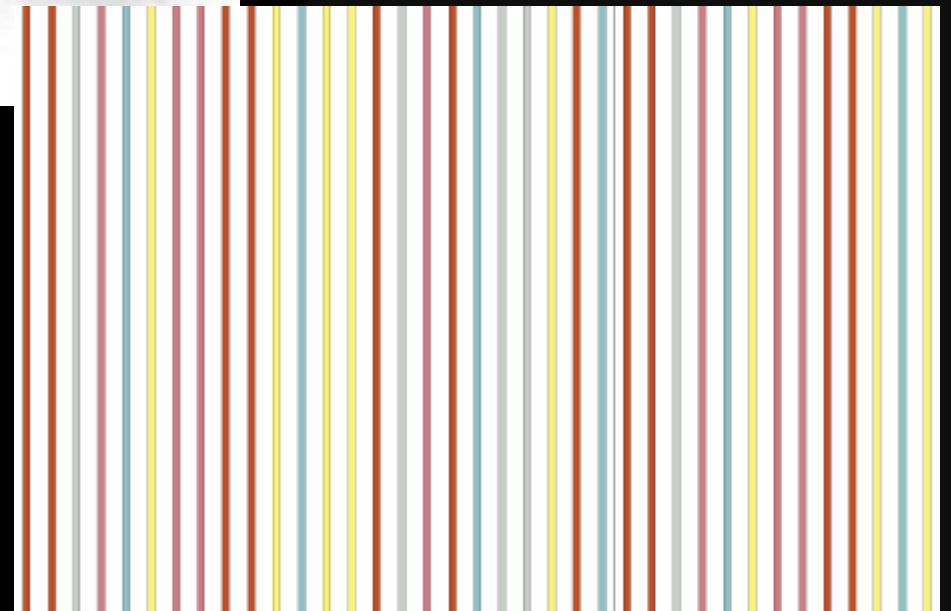









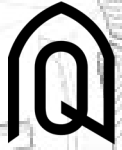

Abbey  
Quarter

URDF 1

URDF 2



Tionscadal Éireann  
Project Ireland  
**2040**

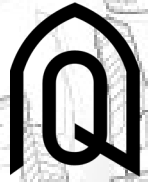

Abbey  
Quarter

URDF 2

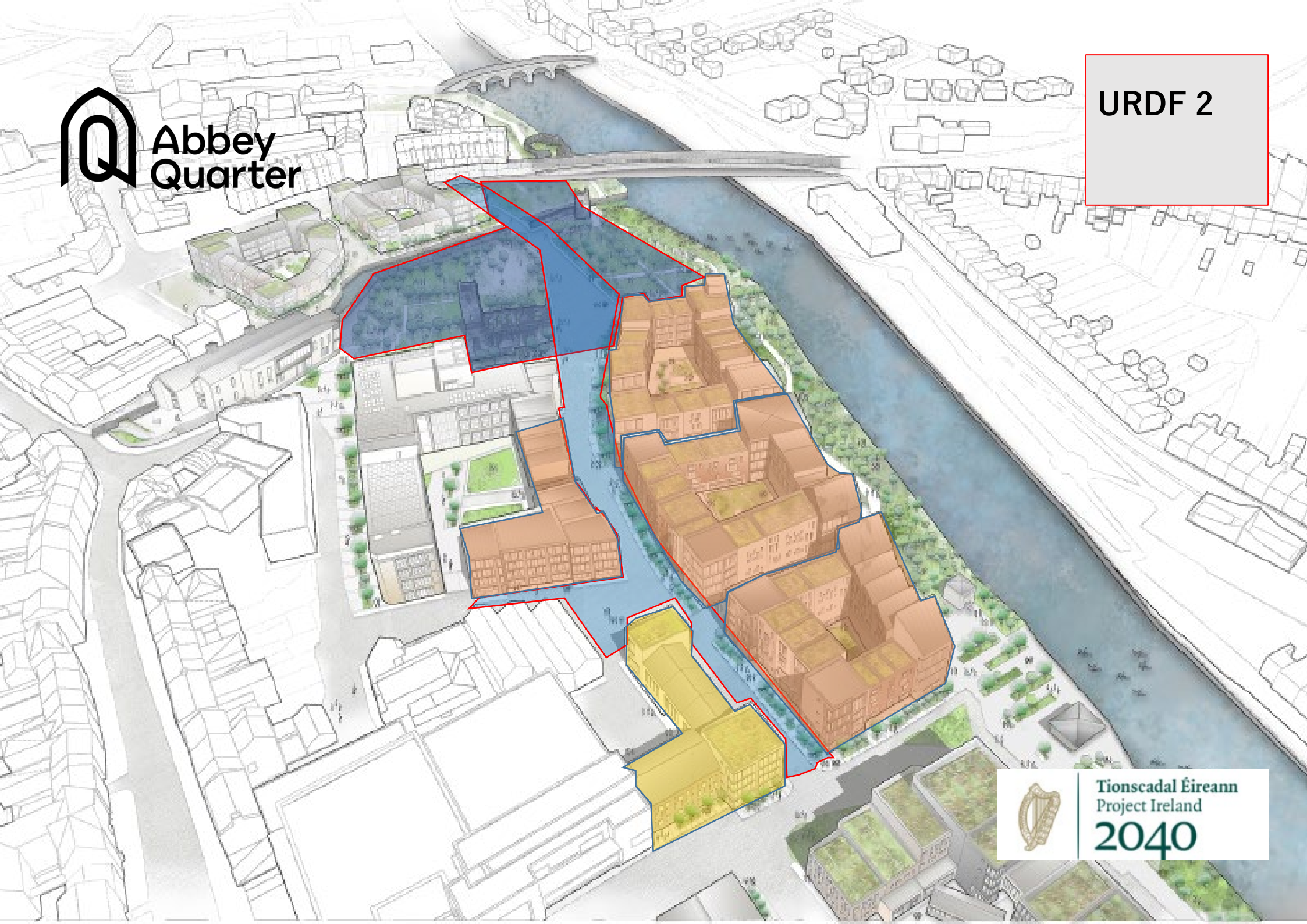



 Abbey  
Quarter





 Abbey  
Quarter







Abbey  
Quarter

URDF 2





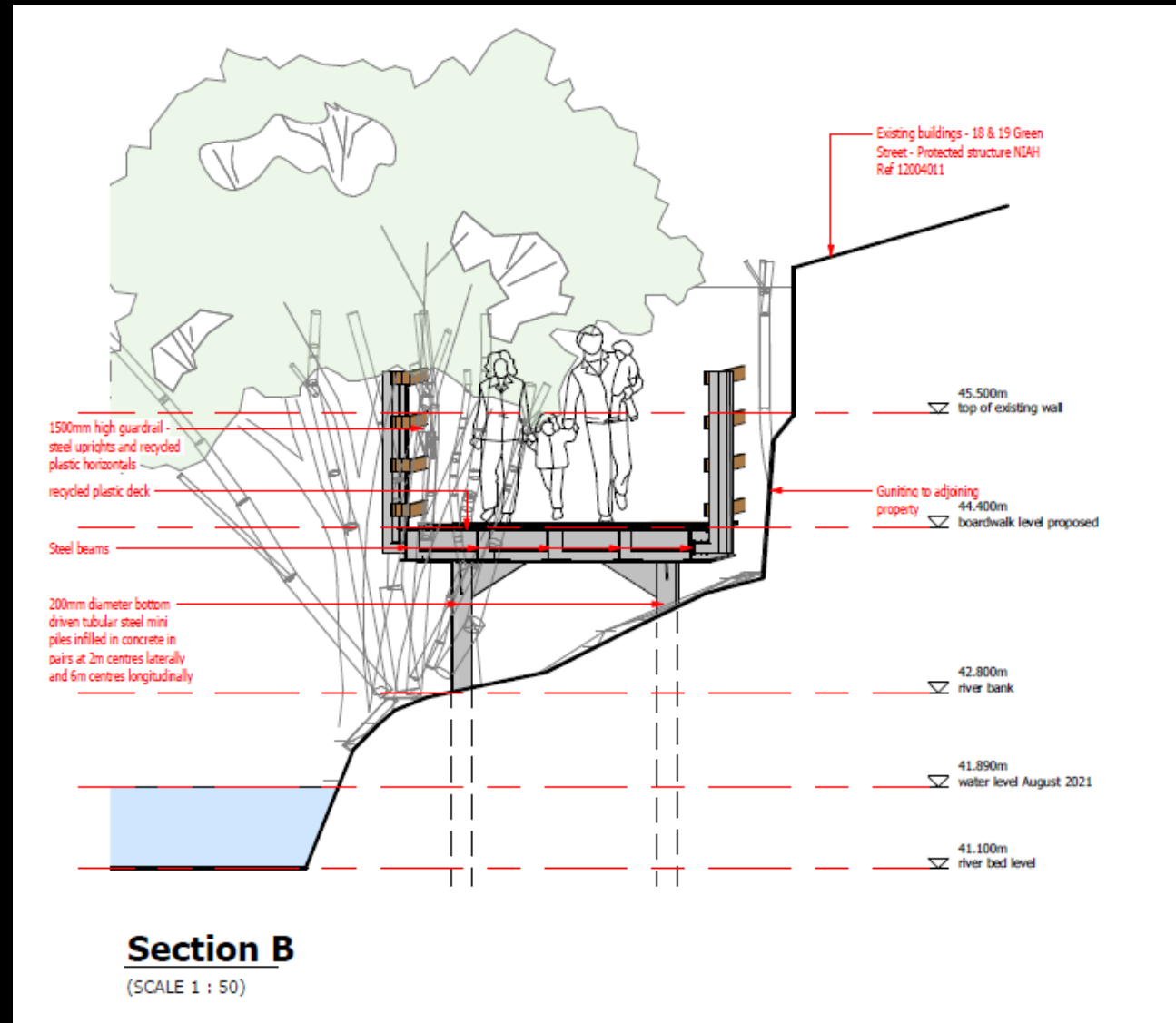

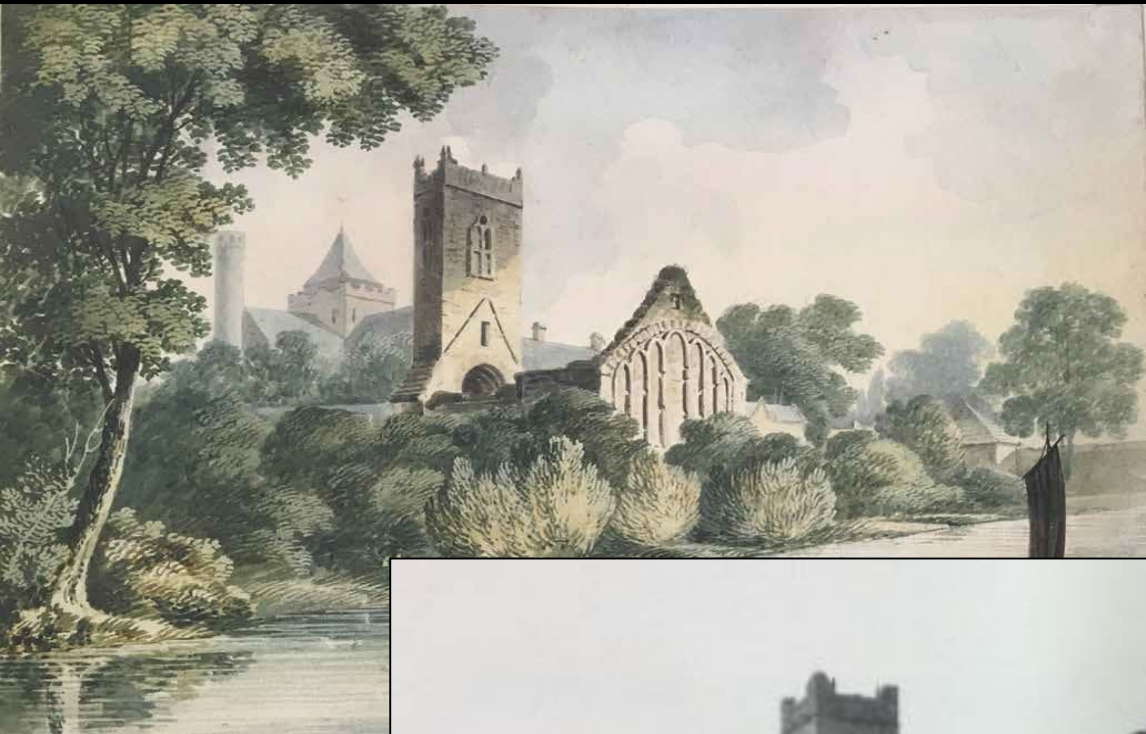

# Conservation Plan





# Conservation Plan



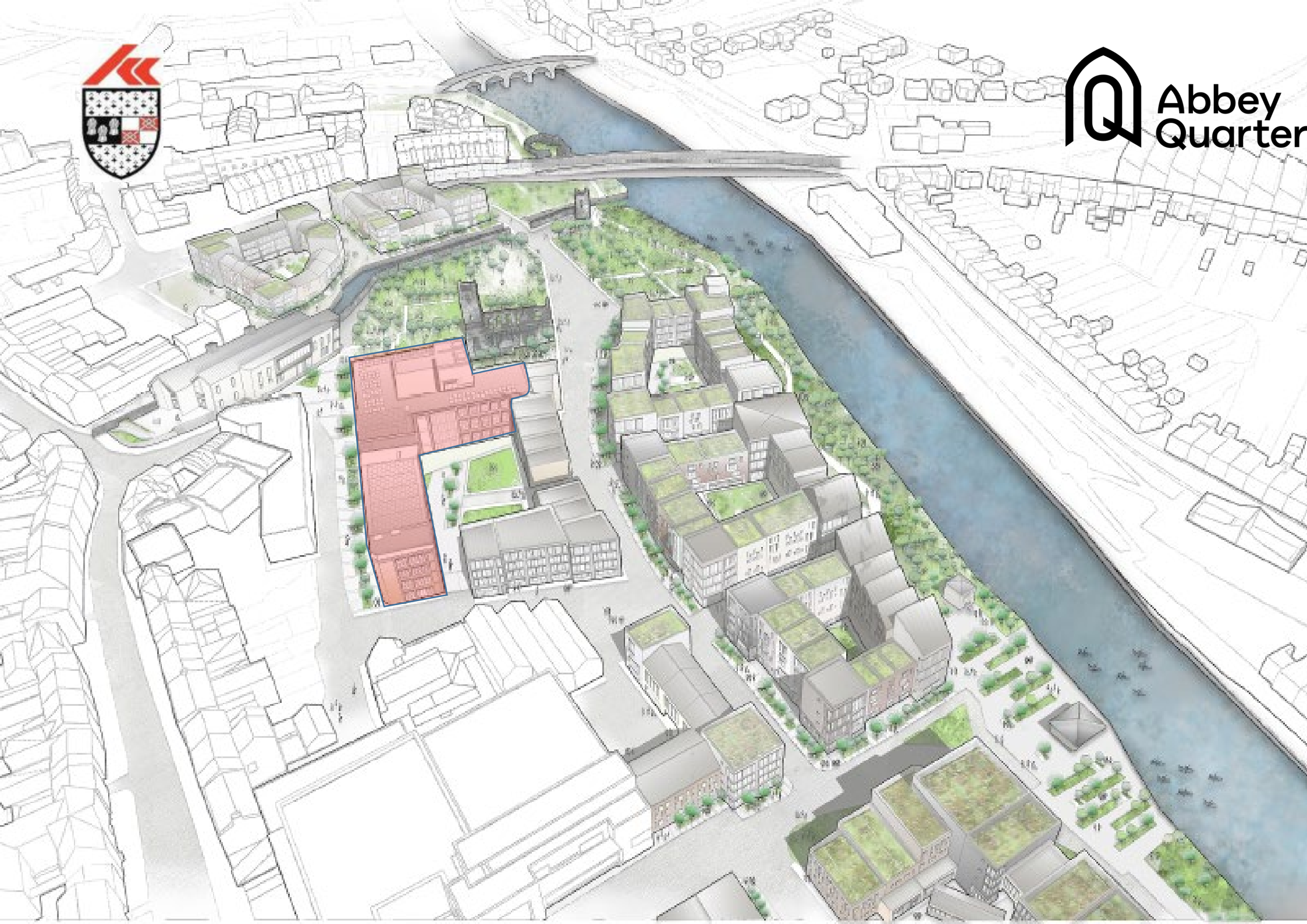





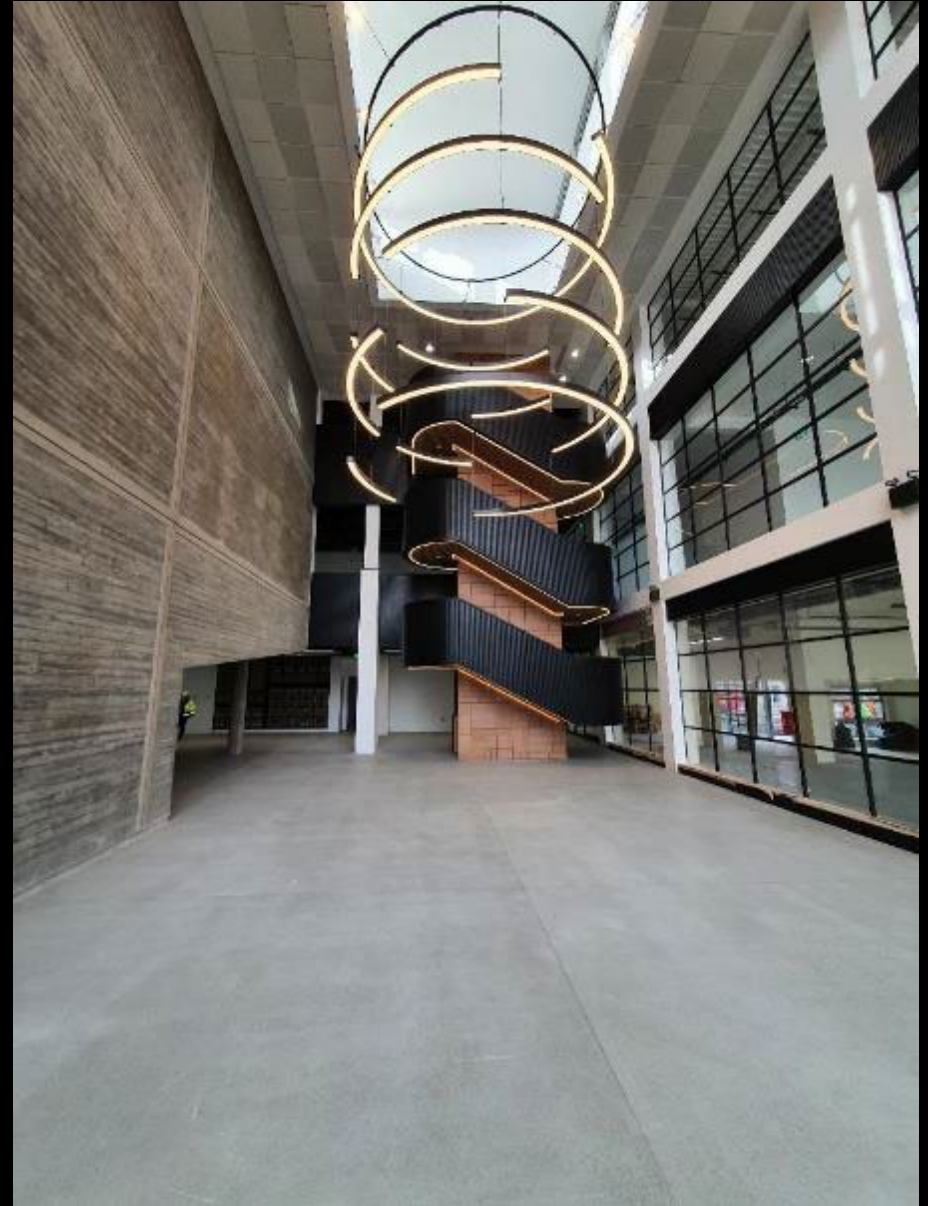





## Brewhouse





### LEED Credit Categories





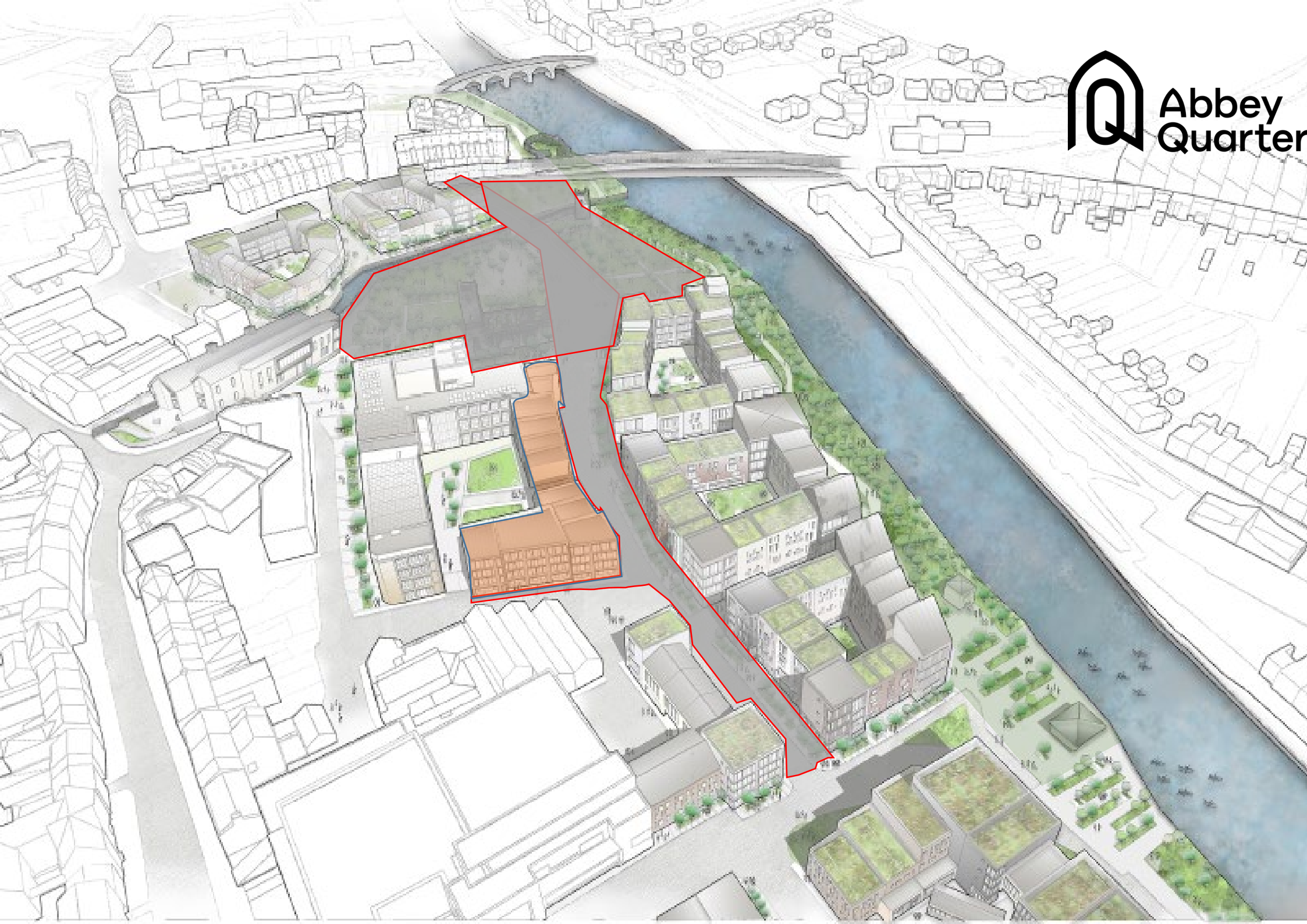

# Building 7

*Offices/Services/Ground Floor Uses*

Kilkenny







Abbey  
Quarter

**HOTEL**





Abbey  
Quarter

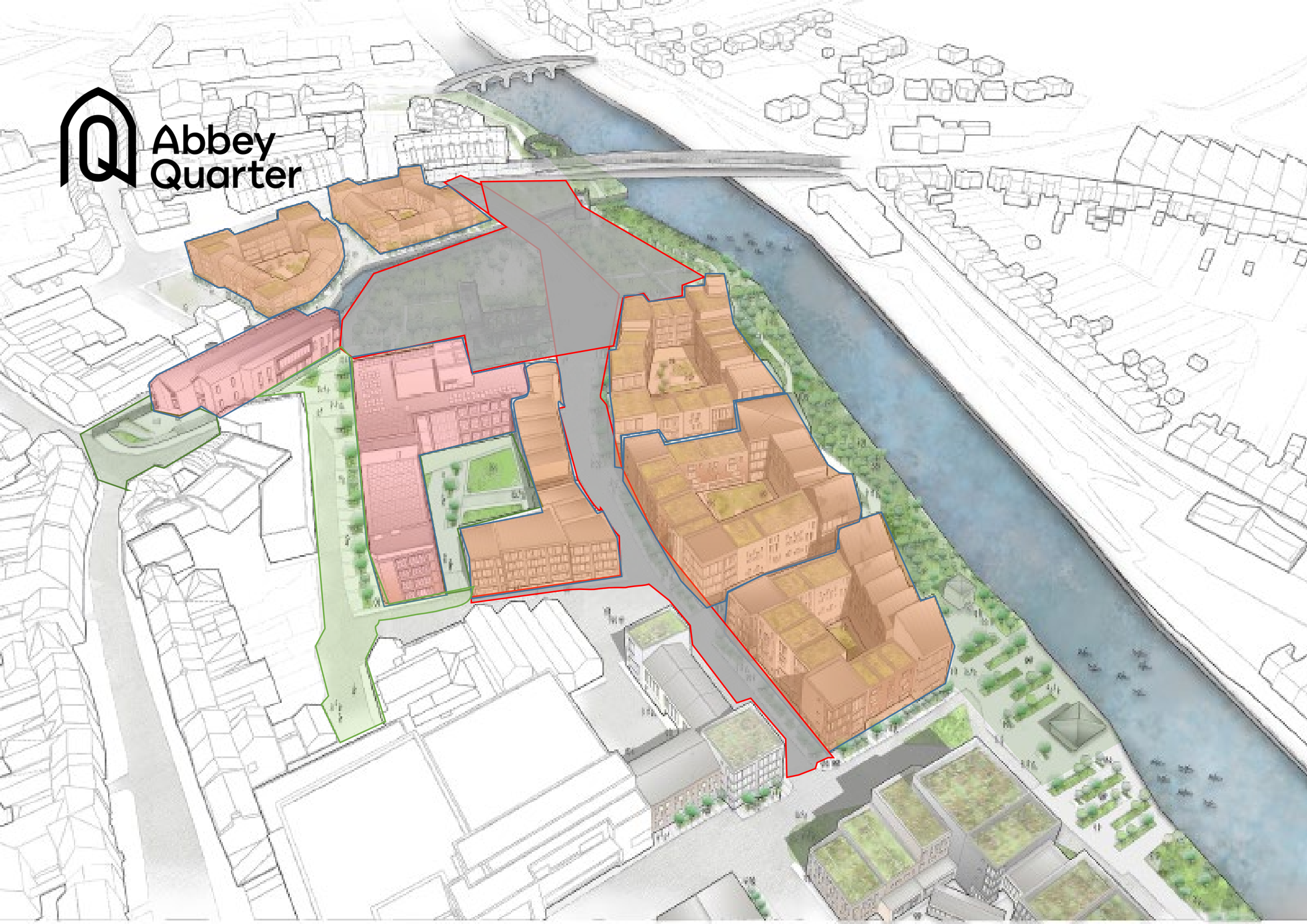



Re Cap

Next Steps

Discussions from this webinar along with the findings of the online survey will be fed into the review.

There will be three further public consultations (two in-person and one online) on publication of the Draft documents.

Publication of Draft end of Feb/early March.

**THANK YOU FOR YOUR ATTENTION**